

MWRA Pipeline Maintenance

Date: 5/24/2017

Security Operational - For MWRA use ONLY

1 inch = 376 feet

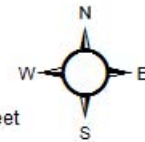
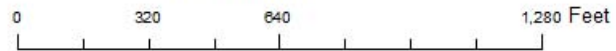



Massachusetts Water Resources Authority
Leakage Control Report
Inspection Branch

Leak No.: FY17-22
 Date: 5/15/2017
 Leak Indication Classification:
 I II **III** (Circle One)
 Service Area: Northern High

Technician: Pyburn, Smokler Town/City: Revere
 Street Address: Beach Street Cross Street: Eaton Street
 Section #: 69 Detail Record #: - Record Plan #: Sheet 1 Date Installed: 1951

ESTIMATED LEAKAGE

5 GPM

INDICATION OF LEAK

Sonic	<input checked="" type="checkbox"/>
Surfaced Water	<input type="checkbox"/>

MATERIAL

Cast Iron	<input checked="" type="checkbox"/>
Steel	<input type="checkbox"/>
Ductile Iron	<input type="checkbox"/>
PCCP	<input type="checkbox"/>
Other	<input type="checkbox"/>

PIPE DIAMETER

24 Inch

LEAK APPEARS TO BE ON:

Main	<input checked="" type="checkbox"/>
Joint	<input type="checkbox"/>
Valve	<input type="checkbox"/>
Valve (Packing)	<input type="checkbox"/>
Blow Off	<input type="checkbox"/>
Air Valve	<input type="checkbox"/>
Other	<input type="checkbox"/>

COVER

Concrete	<input type="checkbox"/>
Asphalt	<input checked="" type="checkbox"/>
Soil	<input type="checkbox"/>

ESTIMATE DEPTH

4 FT

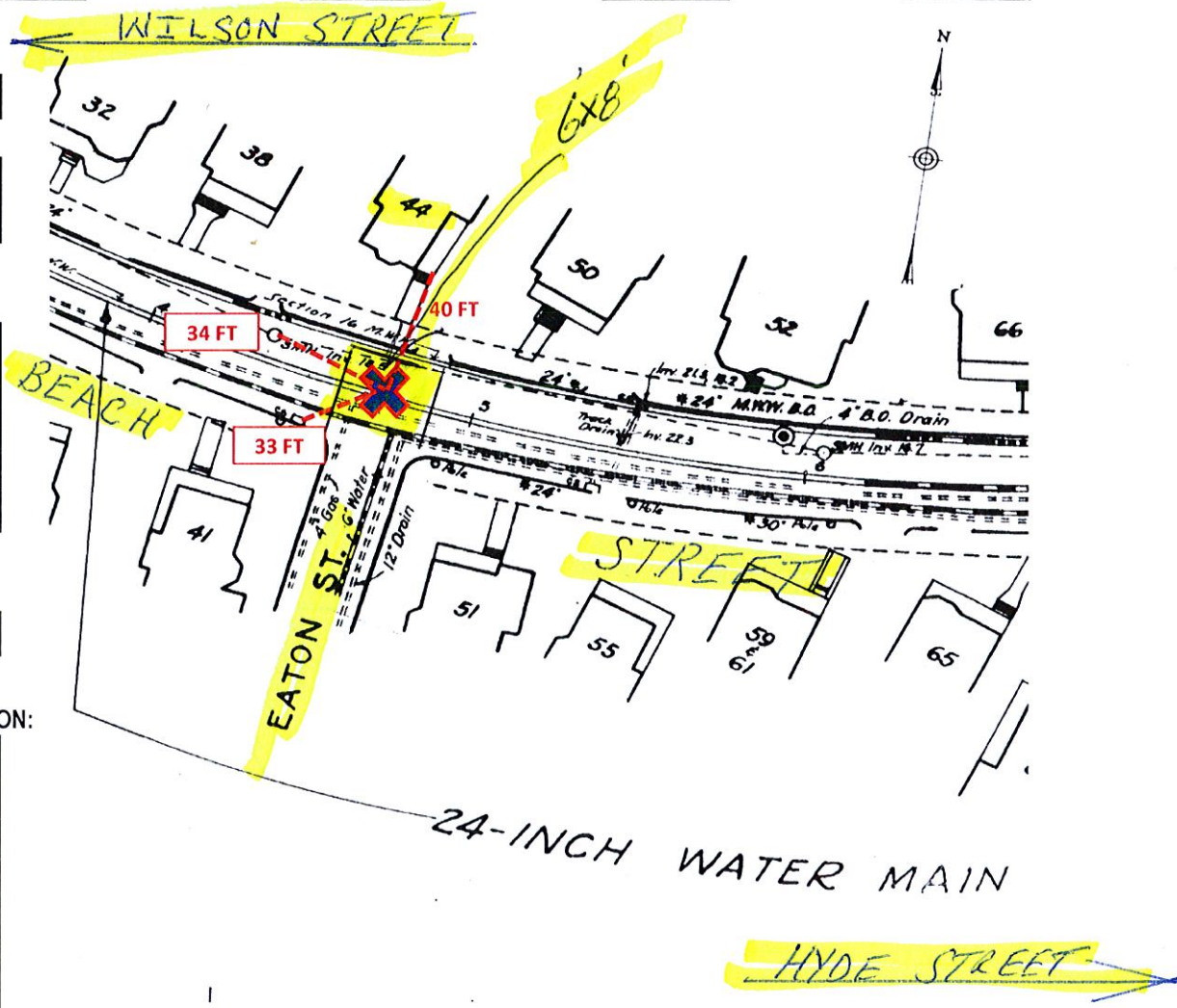

Remarks: Water in road is due to a sump pump which is unrelated to this leak.
